

Battery

The battery of the feature phone is not fully charged.

It is recommended to charge the phone for five hours before using it for the first time. The full capacity of the battery is reached after 3-4 complete charge/discharge cycles.

Warranty

The warranty of this product follows the General Conditions of Delivery and Payment of Pepperl+Fuchs GmbH, which are available at www.pepperl-fuchs.com, or alternatively they can be requested directly from the manufacturer.

Support

E-Mail: support@ecom-ex.com

Note:

Please also observe the safety requirements in the specific safety instructions and the information in the full user guide for your device. The documents can be downloaded from the relevant product page at www.ecom-ex.com

Copyright © 2018 ecom instruments GmbH.

The contents of this document, either in part or in their entirety, may not be reproduced, forwarded, distributed or saved in any way without ecom instruments GmbH prior written consent.

The contents of this document are presented as they currently exist. ecom instruments GmbH does not provide any express or tacit guarantee for the correctness or completeness of the contents of this document, including, but not restricted to, the tacit guarantee of market suitability or fitness for a specific purpose unless applicable laws or court decisions make liability mandatory. ecom instruments GmbH reserves the right to make changes to this document or to withdraw it any time without prior notice.

DOCT-6426 | 01/2019
WEEE-Reg.-Nr. DE 934 99306
Subject to change without notice.

ecom instruments GmbH | Industriestraße 2 | 97959 Assamstadt | Germany
Phone +49 62 94 42 24 0 | Fax +49 62 94 42 24 100
sales@ecom-ex.com | www.ecom-ex.com

ecom
A PEPPERL+FUCHS BRAND



Intrinsically safe feature phone **Ex-Handy 10**

QUICK START GUIDE
THE NEXT GENERATION FEATURE PHONE FOR IIOT

- 1 Receiver
- 2 Proximity/Light sensor
- 3 Alarm key
- 4 Power key
- 5 Touchdisplay
- 6 Home key
- 7 Options key
- 8 Camera key
- 9 End Call/Reject
- 10 Loudspeaker
- 11 Magnetic USB port
- 12 Call/Accept
- 13 Back key
- 14 Volume keys
- 15 PTT key
- 16 Headset port

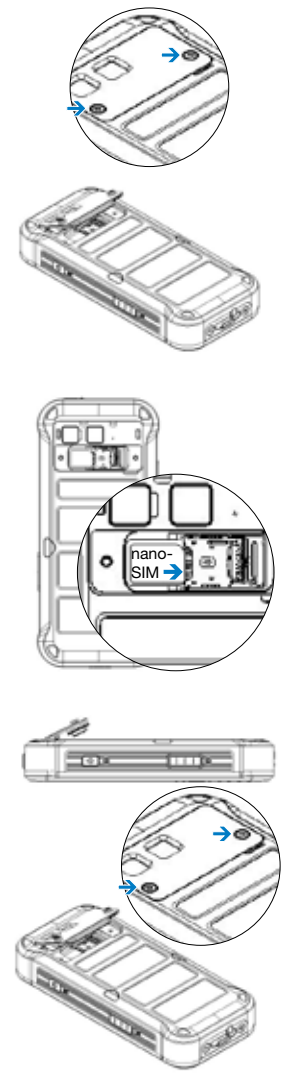

How to insert the nano-SIM card

Step 1

To insert the nano-SIM card unscrew the two cover screws in a counter clockwise direction and remove the SIM card cover.

Please use the screwdriver Torx T8 provided with the device.

Step 2

Insert the nano-SIM card with the gold-colored contacts facing downwards by pushing it upward in the designated slot.

Step 3

Reattach the SIM card cover and screw down the two cover screws in a clockwise direction.

Please use the screwdriver Torx T8 provided with the device and ensure not to overtighten the screws.